

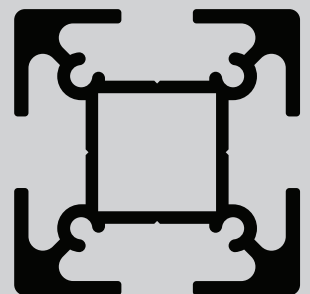

PLANITDESIGN VULCAN NETT

PRICE LIST - FOR OFFICE USE ONLY
ISSUE - AUGUST 2023

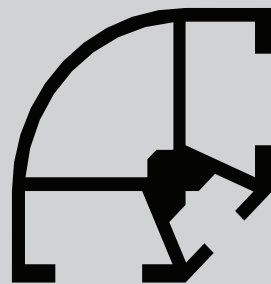
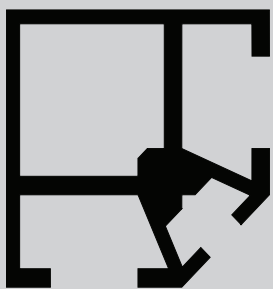

VULCAN NETT PRICE LIST

PLANITDESIGN SYSTEM

EXCLUDING GST – ISSUE AUGUST 2023

Main Frame Aluminium Profiles					
Code	Length	kg/m	Finish	Per Length	Cut per M
OA-1	5.00	0.70	MILL	\$ 40.45	\$ 10.11
			SA	\$ 61.90	\$ 15.48
			PC	\$ 54.40	\$ 13.60
OA-3	5.00	0.60	MILL	\$ 35.85	\$ 8.96
			SA	\$ 56.35	\$ 14.09
			PC	\$ 49.15	\$ 12.29
OA-4	5.00	0.80	MILL	\$ 46.20	\$ 11.55
			SA	\$ 75.00	\$ 18.75
			PC	\$ 64.90	\$ 16.23
OA-5	5.00	0.91	MILL	\$ 52.55	\$ 13.14
			SA	\$ 78.95	\$ 19.74
			PC	\$ 69.70	\$ 17.43
OA-6	5.00	1.38	MILL	\$ 79.70	\$ 19.93
			SA	\$ 120.45	\$ 30.11
			PC	\$ 106.15	\$ 26.54
OA-7	5.00	0.53	MILL	\$ 30.60	\$ 7.65
			SA	\$ 54.90	\$ 13.73
			PC	\$ 46.35	\$ 11.59
OA-8	5.00	0.81	MILL	\$ 46.75	\$ 11.69
			SA	\$ 77.80	\$ 19.45
			PC	\$ 66.90	\$ 16.73
OA-21	5.00	0.43	MILL	\$ 26.00	\$ 6.50
			SA	\$ 40.25	\$ 10.06
			PC	\$ 35.25	\$ 8.81
OA-24	5.00	0.55	MILL	\$ 33.50	\$ 8.38
			SA	\$ 53.45	\$ 13.36
			PC	\$ 46.45	\$ 11.61
OA-25	5.00	0.59	MILL	\$ 35.85	\$ 8.96
			SA	\$ 58.25	\$ 14.56
			PC	\$ 50.40	\$ 12.60
OA-26	5.00	0.74	MILL	\$ 42.75	\$ 10.69
			SA	\$ 67.25	\$ 16.81
			PC	\$ 58.65	\$ 14.66
OA-27	5.00	0.78	MILL	\$ 45.10	\$ 11.28
			SA	\$ 71.75	\$ 17.94
			PC	\$ 62.40	\$ 15.60

VULCAN NETT PRICE LIST

PLANITDESIGN SYSTEM

EXCLUDING GST – ISSUE AUGUST 2023

Supplementary Aluminium Profiles					
Code	Length	kg/m	Finish	Per Length	Cut per M
OA-50	4.00	0.22	MILL	\$ 10.16	\$ 3.18
			SA	\$ 19.12	\$ 5.98
			PC	\$ 16.00	\$ 5.00
OA-51	4.00	0.28	MILL	\$ 12.92	\$ 4.04
			SA	\$ 24.92	\$ 7.79
			PC	\$ 20.72	\$ 6.48
OA-52	4.00	0.22	MILL	\$ 10.20	\$ 3.19
			SA	\$ 18.84	\$ 5.89
			PC	\$ 64.90	\$ 20.28
OA-54	4.00	0.26	MILL	\$ 11.08	\$ 3.46
			SA	\$ 19.72	\$ 6.16
			PC	\$ 16.68	\$ 5.21
OA-55	4.00	0.19	MILL	\$ 28.40	\$ 8.88
			SA	\$ 37.04	\$ 11.58
			PC	\$ 34.00	\$ 10.63
OA-56	4.00	0.19	MILL	\$ 8.80	\$ 2.75
			SA	\$ 17.44	\$ 5.45
			PC	\$ 14.40	\$ 4.50
OA-57	4.00	0.14	MILL	\$ 6.48	\$ 2.03
			SA	\$ 15.12	\$ 4.73
			PC	\$ 12.08	\$ 3.78
OA-58	4.00	0.23	MILL	\$ 10.64	\$ 3.33
			SA	\$ 19.28	\$ 6.03
			PC	\$ 16.24	\$ 5.08
OA-59	4.00	0.19	MILL	\$ 8.76	\$ 2.74
			SA	\$ 17.40	\$ 5.44
			PC	\$ 14.36	\$ 4.49
OA-60	4.00	0.42	MILL	\$ 17.60	\$ 5.50
			SA	\$ 29.16	\$ 9.11
			PC	\$ 25.12	\$ 7.85
OA-61	4.00	0.26	MILL	\$ 12.92	\$ 4.04
			SA	\$ 23.12	\$ 7.23
			PC	\$ 19.52	\$ 6.10
OA-62	4.00	0.27	MILL	\$ 12.92	\$ 4.04
			SA	\$ 21.56	\$ 6.74
			PC	\$ 18.52	\$ 5.79
OA-63	4.00	0.25	MILL	\$ 12.04	\$ 3.76
			SA	\$ 25.24	\$ 7.89
			PC	\$ 20.60	\$ 6.44

VULCAN NETT PRICE LIST

PLANITDESIGN SYSTEM

EXCLUDING GST – ISSUE AUGUST 2023

Cast Connectors			
Code	Description	Finish	Each
OC-1	Square 3 way	Raw	\$ 8.70
OC-1	Square 3 way	Bright Chrome	POA
OC-1	Square 3 way	Designer Silver	\$ 9.90
OC-1	Square 3 way	P/Coat	\$ 11.50
OC-2	Square 2 way	Raw	\$ 8.70
OC-2	Square 2 way	Bright Chrome	POA
OC-2	Square 2 way	Designer Silver	\$ 9.90
OC-2	Square 2 way	P/Coat	\$ 11.50
OC-13	Radius 3 way	Raw	\$ 8.70
OC-13	Radius 3 way	Bright Chrome	POA
OC-13	Radius 3 way	Designer Silver	\$ 9.90
OC-13	Radius 3 way	P/Coat	\$ 11.50
OC-14	Radius 2 way	Raw	\$ 8.70
OC-14	Radius 2 way	Bright Chrome	POA
OC-14	Radius 2 way	Designer Silver	\$ 9.90
OC-14	Radius 2 way	P/Coat	\$ 11.50
OF-1	M5 x 12 Cap Screws	Bright Zinc	\$ 0.14

Aluminium End Caps			
Code	Description	Finish	Each
OAC-5	Top cap to Fit OA-5	Designer Silver	\$ 5.30
OAC-6	Top cap to Fit OA-6	Designer Silver	\$ 5.30
OAC-6 BF	Bottom cap to Fit OA-6	Designer Silver	\$ 10.10
OAC-6 BP100	Base Plate for OA-6	Designer Silver	\$ 38.30

VULCAN NETT PRICE LIST

PLANITDESIGN SYSTEM

EXCLUDING GST – ISSUE AUGUST 2023

Plastic End Caps			
Code	Description	Finish	Each
OPC-1	Top Cap for OA-1 Grey, Black	PVC	\$ 0.78
OPC-1BF	Bottom Foot for OA-1 Grey, Black	PVC	\$ 1.62
OPC-3	Top Cap for OA-3 Grey, Black	PVC	\$ 0.78
OPC-3BF	Bottom Foot for OA-3 Grey, Black	PVC	\$ 1.62
OPC-4	Top Cap for OA-4 Grey, Black	PVC	\$ 0.78
OPC-4BF	Bottom Foot for OA-4 Grey, Black	PVC	\$ 1.62
OPC-8	Top Cap for OA-8 Grey, Black	PVC	\$ 1.05
OPC-21	Top Cap for OA-21 Grey, Black	PVC	\$ 0.56
OPC-24	Top Cap for OA-24 Grey, Black	PVC	\$ 0.78
OPC-27	Insert Plug for OA-1 LTS19-M8	PVC	\$ 3.37
OPC-28	Insert Plug for OA-1 LTS19-M10	PVC	\$ 3.67
OPC-29	Square LED End Cap – White, Grey, Black	PVC	\$ 0.75
OPC-30	Radius LED End Cap – White, Grey, Black	PVC	\$ 0.75
OPC-63	End Cap for OA-63 – Grey, Black	PVC	\$ 0.77

PVC Extrusions				
Code	Description	Length	Per Length	Cut per M
OPE-20	Door Track Filler – Black	4.00	\$ 12.16	\$ 3.80
OPE-21	4mm Wedge – Black	200M / Roll	\$ 364.00	\$ 2.28
OPE-22	5mm Wedge – Black	250M / Roll	\$ 325.00	\$ 1.63
OPE-23	6mm Wedge – Black	300M / Roll	\$ 396.00	\$ 1.65
OPE-24	Door Wedge – Clear	100M / Roll	\$ 246.00	\$ 3.08
OPE-25	Flush Top – Clear	4.00	\$ 23.08	\$ 7.21
OPE-26	Door Track – Black	4.00	\$ 21.04	\$ 6.58
OPE-26	Door Track – Grey	4.00	\$ 21.04	\$ 6.58
OPE-27	10mm Track Filler – Black	25M / Roll	\$ 81.25	\$ 4.06
OPE-27	10mm Track Filler – Grey	25M / Roll	\$ 81.25	\$ 4.06
OPE-28	5mm Track Filler – Black	25M / Roll	\$ 60.25	\$ 3.01
OPE-28	5mm Track Filler – Grey	25M / Roll	\$ 60.25	\$ 3.01
OPE-29	LED Flat Diffuser – Clear	4.00	\$ 22.85	\$ 7.14
OPE-29	LED Flat Diffuser – Opal	4.00	\$ 26.65	\$ 8.33
OPE-30	LED Radius Diffuser – Clear	4.00	\$ 24.25	\$ 7.58
OPE-30	LED Radius Diffuser – Opal	4.00	\$ 26.50	\$ 8.28
OPE-32	Polybond	450M / Roll	\$ 252.00	\$ 0.70

VULCAN NETT PRICE LIST

PLANITDESIGN SYSTEM

EXCLUDING GST – ISSUE AUGUST 2023

Plastic Accessories			
Code	Description	Kg / 100	Each
OPA-30	Single Glass Support – Clear		\$ 0.31
OPA-32	Glass Corner Holder – Clear		\$ 0.63
OPA-36	Shelf s/clip-top – Grey, Black		\$ 0.50
OPA-37	Shelf s/clip-bottom – Grey, Black		\$ 0.49
OPA-38	Glass Edge Protector – Clear		\$ 0.53
OPA-39	Beam Lock – White Housing		\$ 0.50
OPA-40	Beam Lock – Grey Housing		\$ 0.63

Hardware Accessories			
Code	Description	Kg Each	Each
OH-1	Alum. Threaded M6 Insert – OA-7		\$ 2.94
OH-2	Levelling Glide M6 x 36 Dia.		\$ 2.15
OH-3	Levelling Glide M8 x 22 Dia.		\$ 2.88
OH-4	Levelling Glide M8 x 38 Dia.		\$ 4.65
OH-5	Heavy Duty Swivel M8		\$ 17.10
OH-5A	Heavy Duty Brake M8		\$ 19.30
OH-6	Alum. Shelf Peg Assembly		\$ 3.07
OH-7	Heavy Duty Angle Shelf Peg		\$ 8.92
OH-8	200 Shelf Bracket		\$ 4.97
OH-9	250 Shelf Bracket		\$ 6.65
OH-10	300 Shelf Bracket		\$ 7.28
OH-11	350 Shelf Bracket		\$ 9.38
OH-12	Fixing Angle Bracket		\$ 3.01
OH-13	Angle Connector 40 x 40		\$ 2.45
OH-14	Glass Door Side Mount – Chrome	Pair	\$ 25.94
OH-15	Glass Door Pivot Hinge – Chrome	Pair	POA
OH-16	Plunger Lock		\$ 13.68
OH-17	Cam Lock		\$ 58.21
OH-18	Door Roller		\$ 6.93
OH-19	Finger Pulls – Chrome		\$ 2.69
OH-20	M8 Insert for OA-6 Base Plate		\$ 4.34
OH-22	Beam Lock – Side insertion White		\$ 6.84
OH-23	Beam Lock – Top insertion Grey		\$ 6.96
OH-24	Pivot Connector		\$ 9.00

VULCAN NETT PRICE LIST

PLANITDESIGN SYSTEM

EXCLUDING GST – ISSUE AUGUST 2023

Hardware Accessories			
Code	Description	Kg Each	Each
OF-1	M5 x 12 Cap Screw		\$ 0.14
OF-2	M6 x 3/4 S/S CSK. Posi – For OA-6 Cap		\$ 0.17
OF-3	M6x16 CSK Socket Screw		\$ 0.27
OF-6	M5 x 16 s/s Cone point grub screw		\$ 0.25
OF-7	M8 x 10 s/s Cone Head – Beam Lock		\$ 0.21
OF-8	Beam Lock Spring – 9.5 OD x 23 FL x 8TT		\$ 0.15
OF-9	Retaining Clip – LED Extrusion OA-59		\$ 0.66
OF-10	M6 Locking Nut		\$ 2.52
OF-11	M8 Locking Nut		\$ 2.52
Code	Description	Kg Each	Each
OF-12	2 Stage Drill Bit		POA
OF-13	D-Plug Drill Bit		POA
OF-14	Plankwall Edge Router		POA
OF-15	Beam Lock – Bayonet Housing Block		\$ 2.59
OF-16	Beam Lock – Bayonet Side Insertion		\$ 3.36
OF-17	Beam Lock – Bayonet Top / Bott. Insertion		\$ 3.36
OF-18	M6 Locking Nut for OA-5 and OA-7		\$ 2.52
Code	Description	Kg Each	Per 100
OF-21	4mm Allen Key		POA
OF-22	2.5mm Allen Key		POA
Code	Description	Kg Each	Each
OF-30	Drill Jig for Beam Lock		\$ 255.60
OF-32	Drill Jig for Cast Connector		\$ 296.40
OF-34	Hand Punch for Beam Lock		\$ 1,155.00



www.planitdesign.co.nz